

TOP VIEW OF ARM, GUARDS, SPACER #28 DETAIL, SET SCREW FOR HANDLE, AND FASTENERS FOR INTERNAL WHEEL GUARD

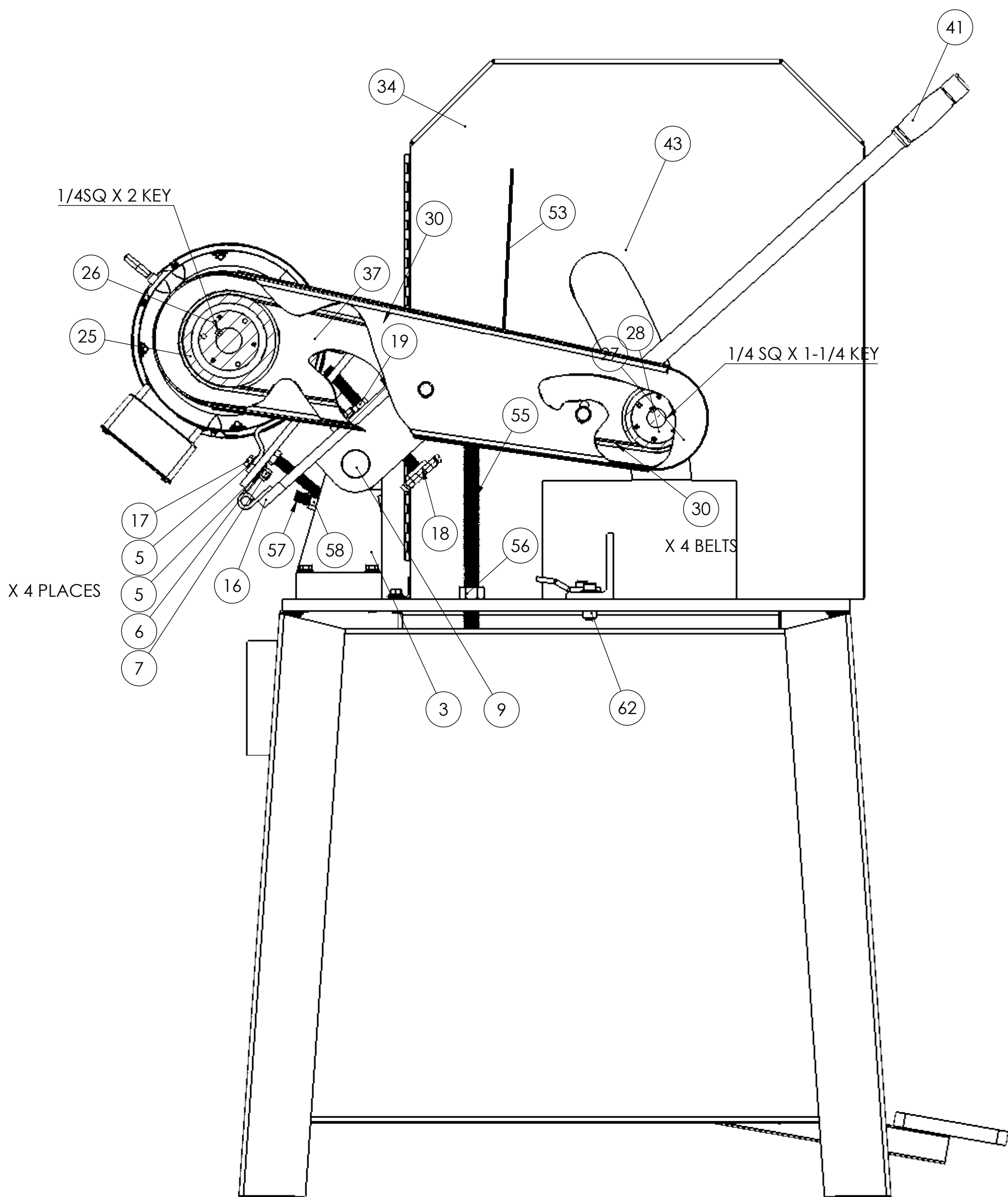

LEFT SIDE VIEW

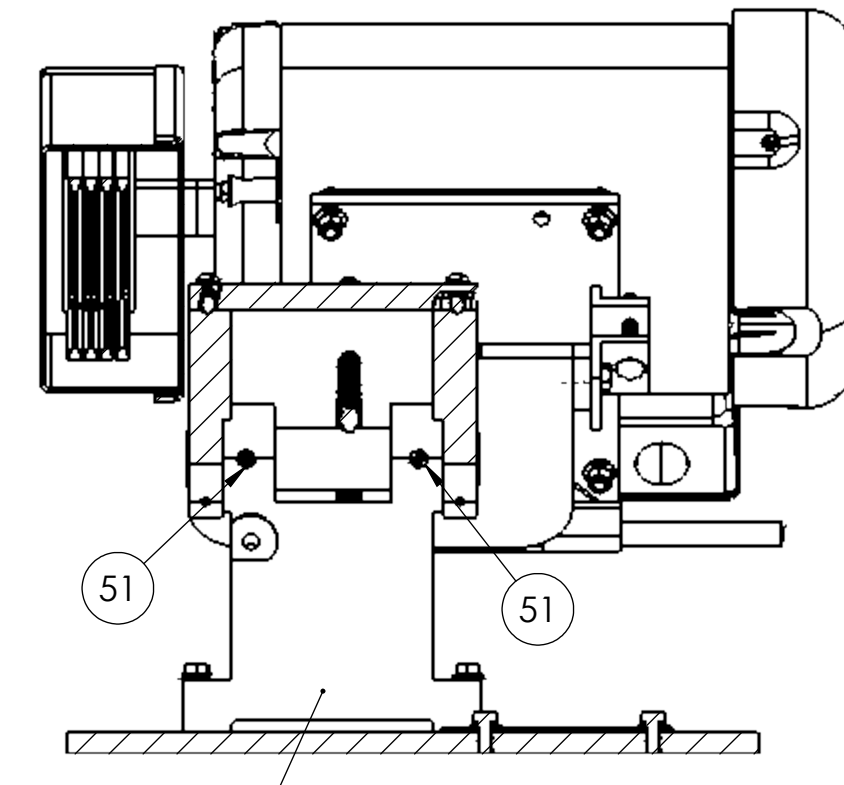
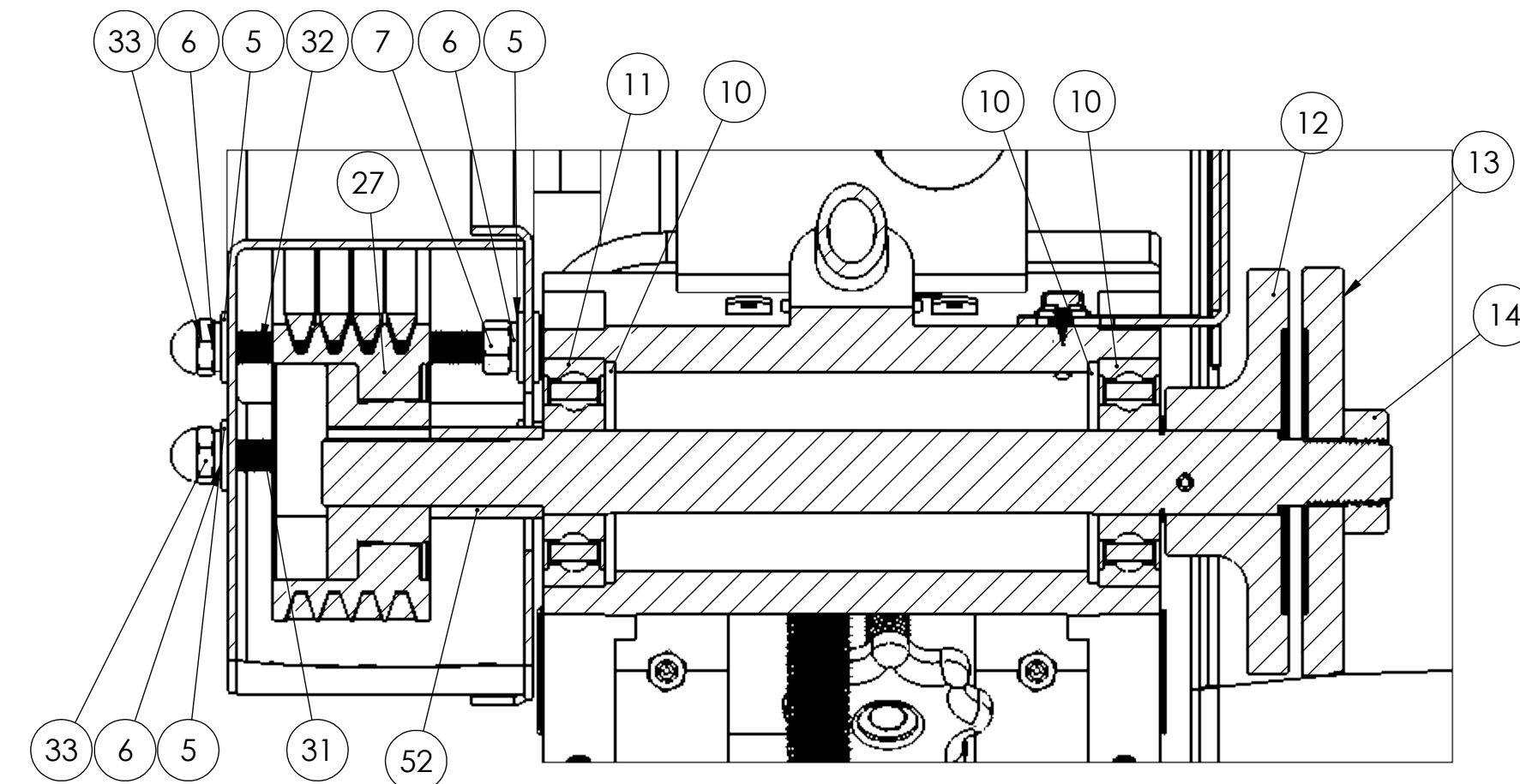
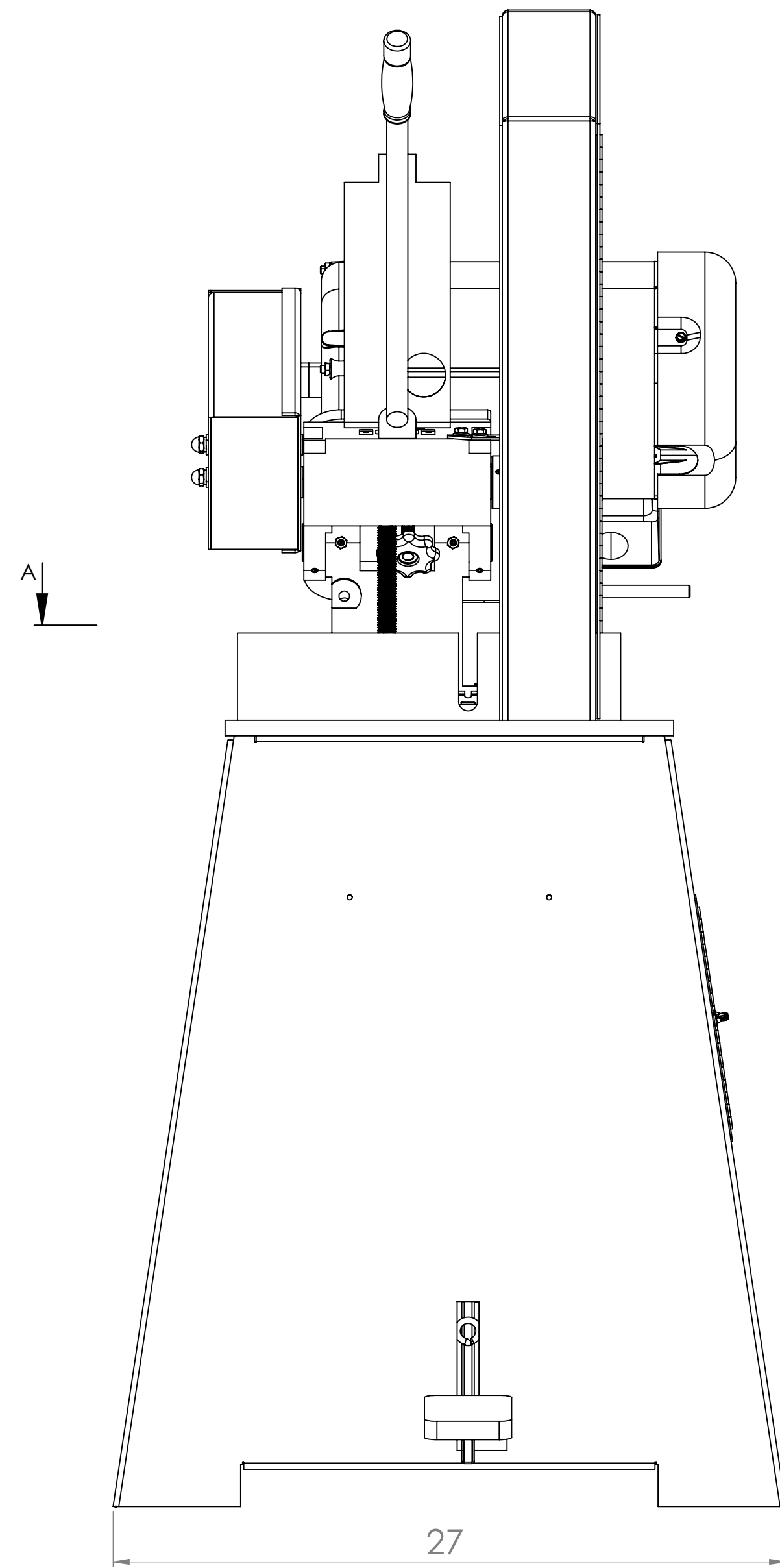

FRONT VIEW

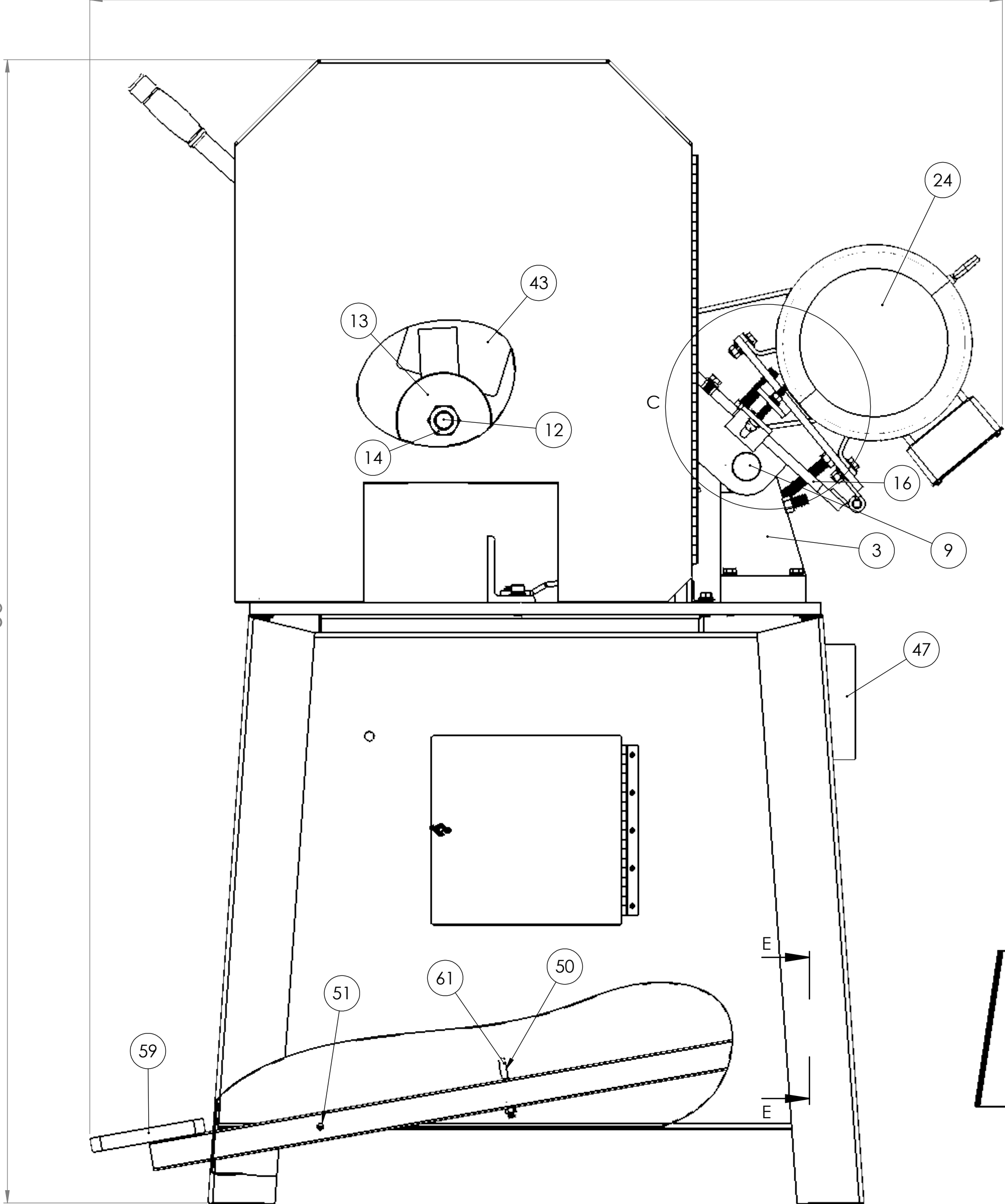

RIGHT SIDE VIEW

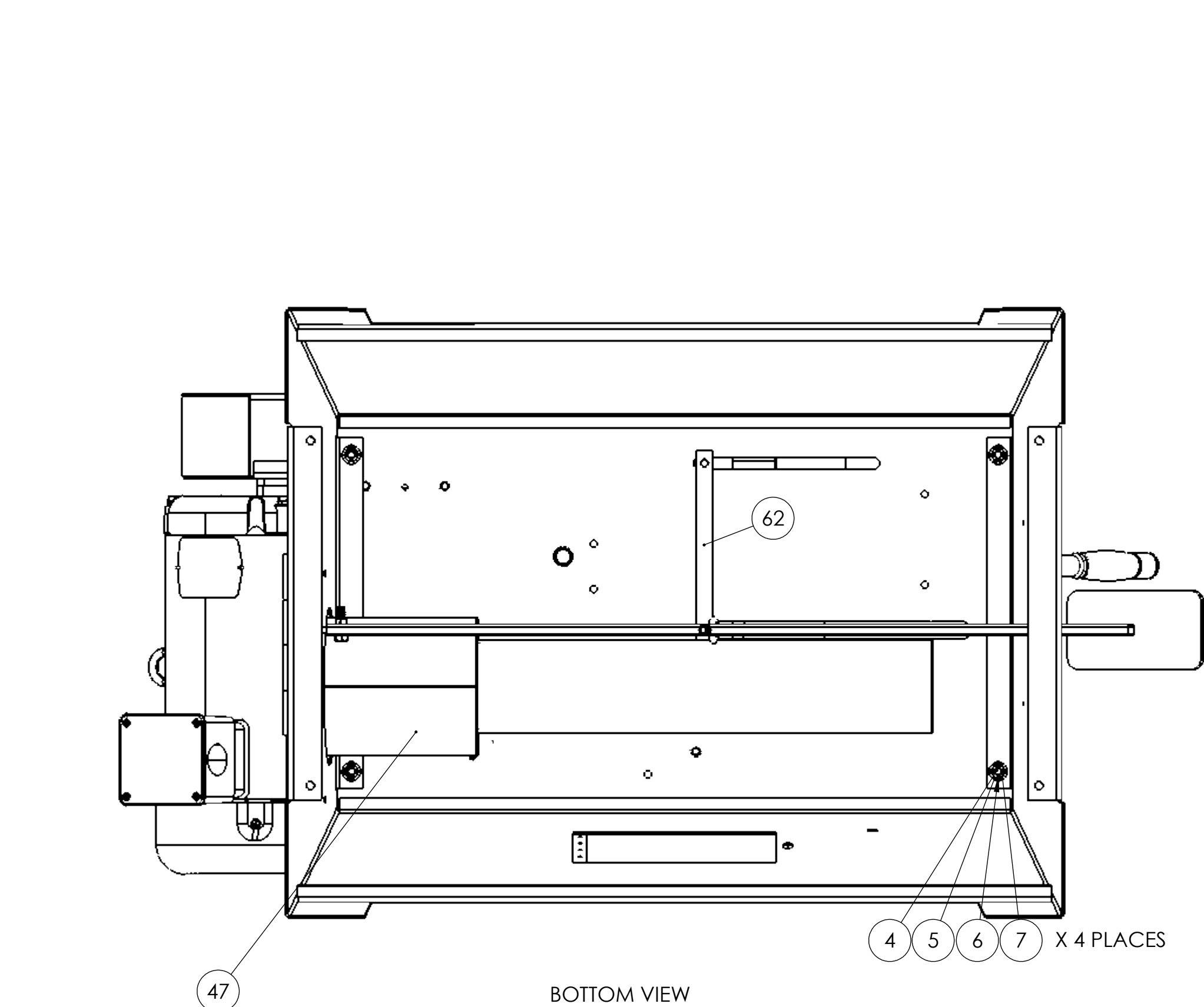

BOTTOM VIEW

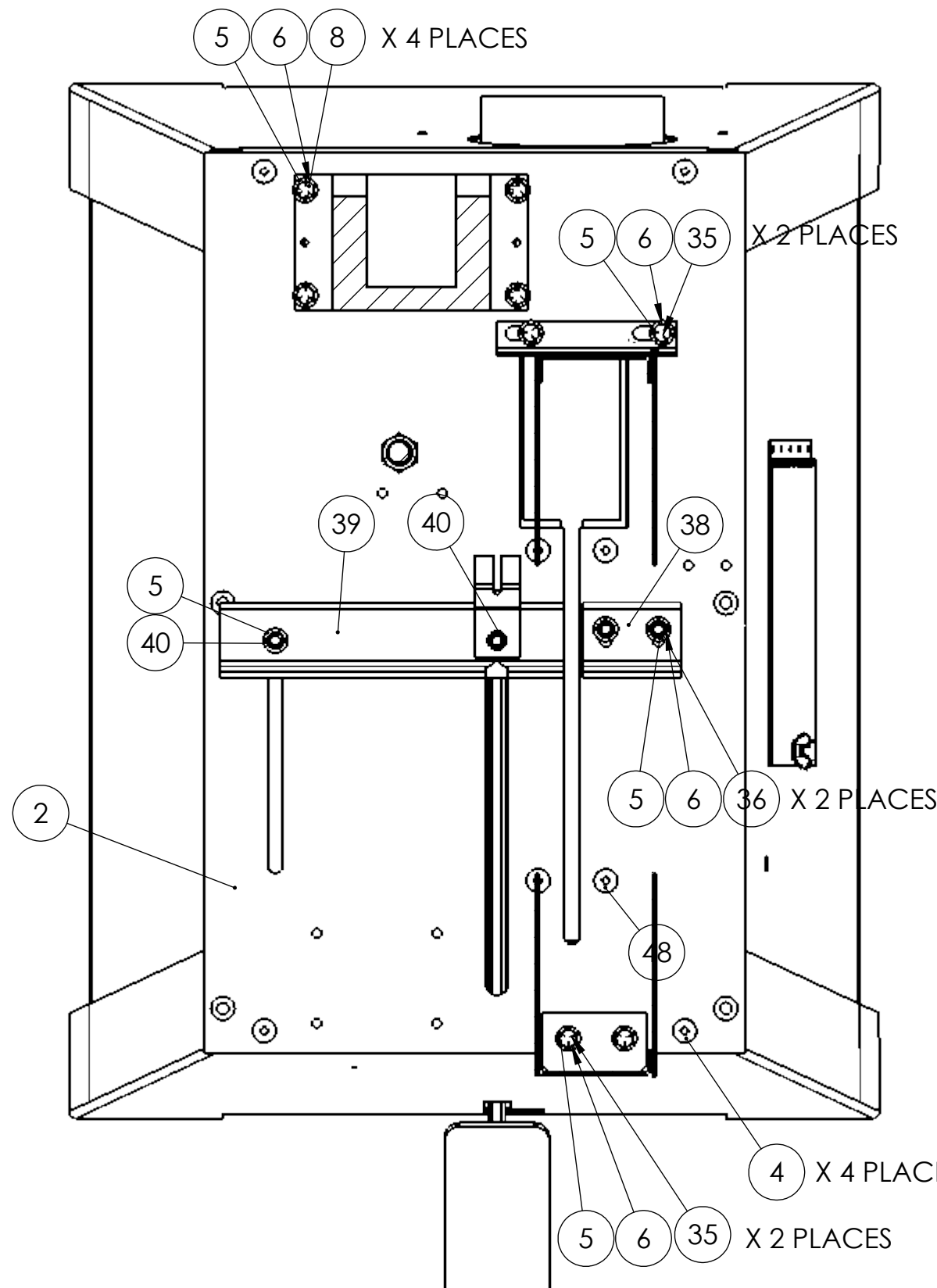

SECTION A-A
MOUNTING TO BASE PLATE

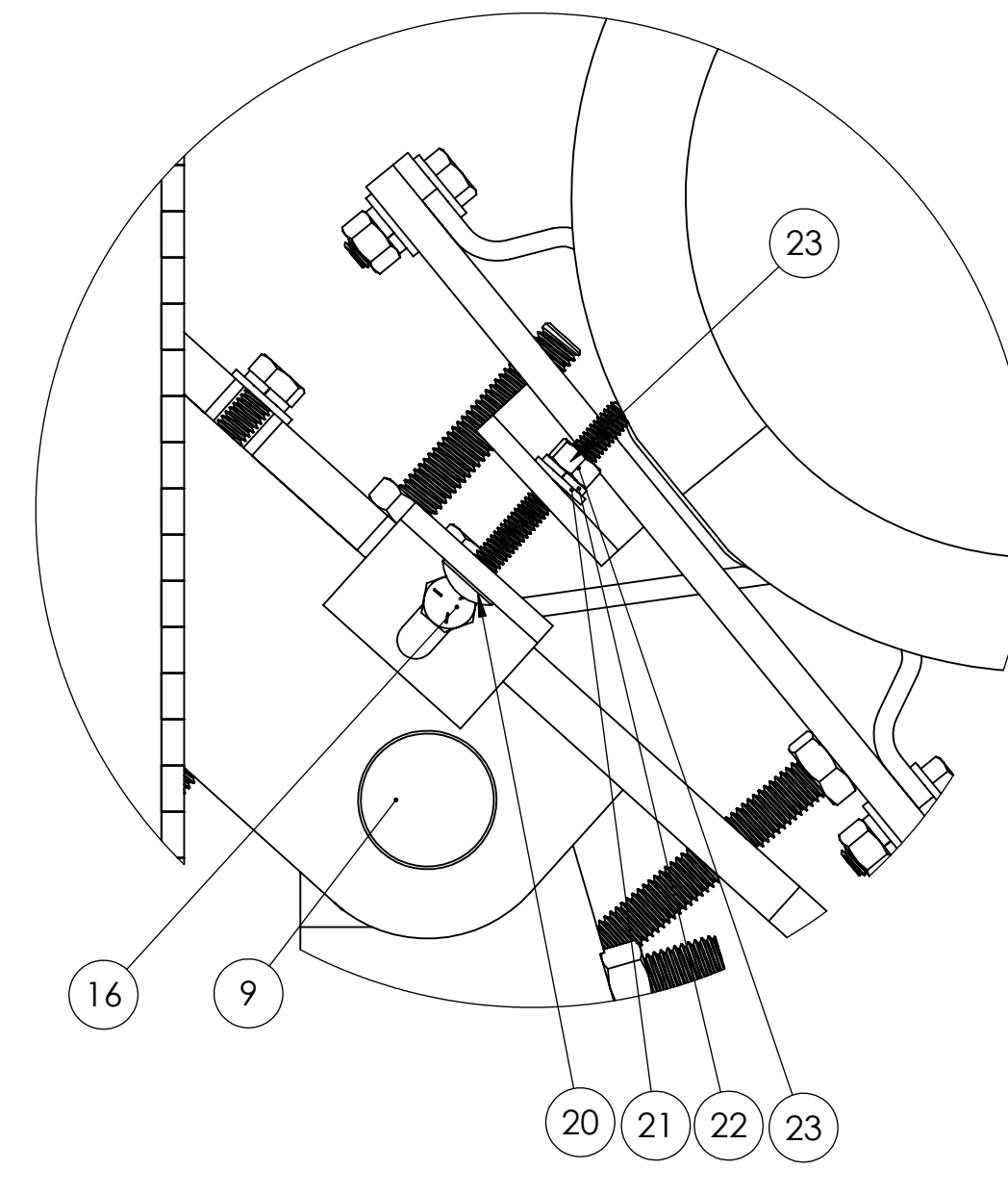

DETAIL C
SCALE 1:2

ITEM NO.	PART NUMBER	DESCRIPTION	QTY.
1	716-027	STAND ASSEMBLY FOR K20SSF	1
2	050-019A	BASE, PLATE FOR K20SSF (NEW STYLE)	1
3	831-021	TRUNNION FOR KM16-18, K16-18, K20SSF (NEW STYLE)	1
4	FSCA037020	3/8-16 X 1-1/4 FSHCS	4
5	UFW2037	3/8 USS F/W Z	33
6	SLW2037	3/8 SPLIT L/W Z	28
7	FHN5037	3/8-16 FHN GR5 Z	11
8	HHC5037036	3/8-16 X 2-1/4 HHC5 GR 5 Z	4
9	700-003	NEW STYLE TRUNNION PIN FOR K16-18, KM STYLE TRUNNION, K20SSF	1
10	002-005	SAW ARM FOR K16-18, KM16-18, AND K20SSF SAW	1
11	044-004	K20 SPINDLE BEARING	2
12	701-010	SPINDLE W TIGHT FLANGE FOR K16-18, K20SSF, K20E SAWS	1
13	292-011	LOOSE FLANGE FOR K16-20, KM16-18, KM20-22	1
14	537-027	SPINDLE NUT FOR K16-20	1
15	SSKA031006	5/16-18 X 3/8 SOC SET KNURL PT.	2
16	486-010	MOTOR MOUNT PLATE FOR K16-20 ASSEMBLY	1
17	HHC5037020	3/8-16 X 1-1/4 HHC5 GR5 Z	8
18	696-029	MOTOR PLATE TENSION SCREW FOR K16-20 SAWS	1
19	FJNZ050	1/2-13 F H JAM NUT Z	1
20	CRBZ031040	5/16-18 X 2-1/2 CARRIAGE BOLT Z	1
21	UFW2031	5/16 USS F/W Z	1
22	SLW2031	5/16 SPLIT L/W Z	1
23	FHN5031	5/16-18 FHN GR5 ZINC	2
24	486-020	15HP MOTOR FOR K20SSF-15, K20SW-15, KM20-22/15, K20FS, K20E	1
25	560-046	MOTOR PULLEY SHEAVE FOR K16-18, KM16-18, K20SSF-15, KM20-22/15, KM20-22W/15	1
26	049-003	(K20SSF 7 1/2 HP) SPINDLE PULLEY SHEAVE FOR K20SW-15HP & 20HP	1
27	560-047	MOTOR PULLEY BUSHING FOR FOR K16-18, KM16-18, K20SSF-15, K20RS-15, K20SW-15	1
28	049-004	SPINDLE PULLEY BUSHING FOR K16-18, KM16-18, K20SSF-15, K20RS-15, K20SW-15	1
29	0.75DIA X 0.875 LONG CRS	7/8 LONG OF 3/4 ROUND CRS 1018	1
30	051-005	V-BELT FOR K16-18, K20SSF, K20E, K20RS, K20SW	4
31	RND-0.375-16X6.25	6-1/4 INCHES OF 3/8-16 THREADED ROD	1
32	RND0.375-16X5.375	5-3/8 INCHES OF 3/8-16 THREADED ROD	1
33	CPN2037	3/8-16 CAP NUT NICKEL	2
34	342-013	STANDARD WHEEL GUARD FOR K20SSF	1
35	HHC5037016	3/8-16 X 1 HHC5 GR5 Z	4
36	SHCA037020	3/8-16 X 1-1/4 SHCS	2
37	342-039A	GUARD, INNER BELT FOR K16-18, KM16-18, K20SSF SAWS	1
38	293-003	FENCE, RIGHT FOR K16-18, K20SSF	1
39	293-002	FENCE, LEFT FOR K16-18, K20SSF	1
40	SHCA037024	3/8-16 X 1-1/2 SHCS	2
41	381-009	HANDLE WITH GRIP FOR K16-20 ABRASIVE SAW	1
42	SSKA025006	1/4-20 X 3/8 SOC SET KNURL PT.	1
43	342-030	INNER WHEEL GUARD FOR K16-18, K20SSF SAWS	1
44	HHC5025012	1/4-20 X 3/4 HHC5 GR5 Z	2
45	SLW2025	1/4 SPLIT L/W Z	4
46	UFW2025	1/4 USS F/W Z	2
47	168-003	VACUUM SPARK CHUTE FOR K20SSF BASE	1
48	FSCA037016	3/8-16 X 1 FSHCS	4
49	697-021	SPRING FOR HOOK CHAIN ASSY FOR K16-18 AND K20SSF CHAIN VISE	1
50	697-022	SPRING, FOOT PEDAL FOR K16-18 AND K20SSF SAWS	2
51	ZERK012000	1/8-27 X 1 1/16 STRT LUBE FITTING	2
52	049-116	SPACER BUSHING FOR K20/15HP SERIES SPINDLE	1
53	041-092	SWITCH BRACKET FOR MAG SWITCH ON K20 ARM	1
54	HHC5025008	1/4-20 X 1 1/2 HHC5 GR5 Z	2
55	709-003	STOP, DOWN FOR K16-18 AND K20SSF SAWS	1
56	FHN5075	3/4-10 FHN GR5 Z	1
57	RND-0.5-13 THRD ROD X 1.75 LONG	1-3/4 INCHES OF 1/2-13 THREADED ROD	1
58	FHN5050	1/2-13 FHN GR5 Z	1
59	041-007	FOOT PEDAL/ CHAIN ASSEMBLY KOR K16-18 AND K20SSF	1
60	HHC5031020	5/16-18 X 1-1/4 HHC5 GR 5 Z	1
61	TEBZ031032	5/16X2 TURNED EYE BOLT Z	1
62	537-007	LONG FENCE NUT FOR K16-20 SAWS	1
63	342-039	OUTER GUARD, BELT FOR K16-18 AND K20SSF SAWS	1

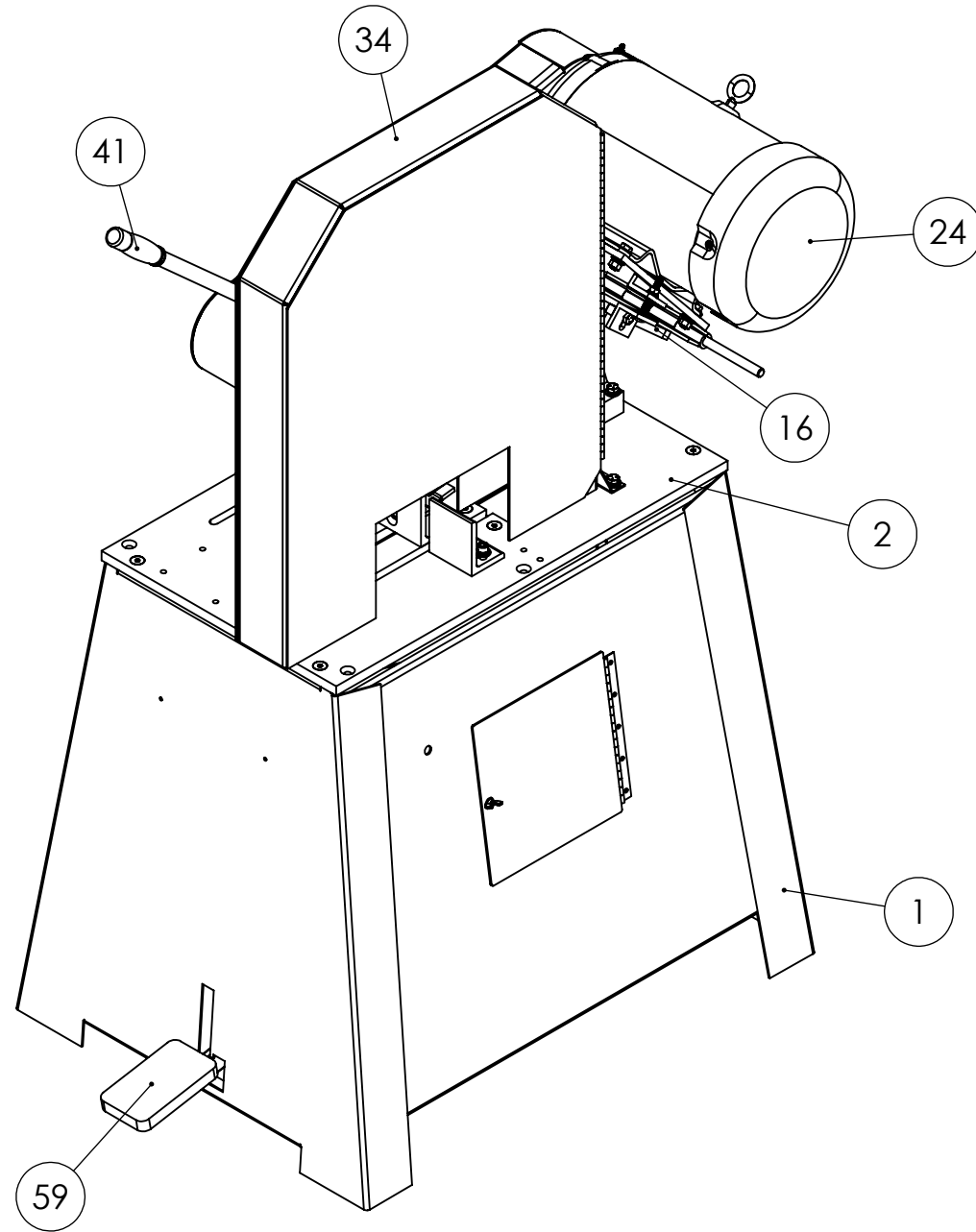

UNLESS OTHERWISE SPECIFIED:	NAME	DATE
DRAWINGS ARE IN INCHES		
FRACTIONS ARE IN 16THS		
ANGULAR DIMS ARE IN DEGS		
THREE PLACE DECIMALS		
INTERFERE GEOMETRIC TOLERANCES PER ASSEMBLY		
DO NOT SCALE DRAWING		

TITLE: **K20SSF-15 ASSEMBLY**
 SIZE: DWG. NO. **K20SSF-15 ASSEMBLY**
 SCALE: 1:5 WEIGHT: SHEET 1 OF 1

